

ORDINANCE NUMBER 12-16

AN ORDINANCE TO THE CITY OF SOMERSET, KENTUCKY, ANNEXING BY CONSENT PROPERTY AS DESCRIBED BELOW AND IN ATTACHMENTS TO THIS ORDINANCE, ATTACHMENTS INCORPORATED IN FULL BY REFERENCE HEREIN; AND

WHEREAS, ANNEXATION REQUEST FORMS HAVE BEEN SUBMITTED BY THE PROPERTY OWNERS, AND THE FORMS HAVE BEEN ACCEPTED BY THE CITY AS COMPLETED; AND THE PROPERTY OWNERS EACH HAVING WAIVED THE 60 DAY WAITING PERIOD, BY AND THROUGH THE ANNEXATION REQUEST FORM, SIGNED BY THE OWNER AND/OR AN AUTHORIZED AGENT OF THE OWNER AND INCORPORATED IN FULL HEREIN BY REFERENCE, AND MADE PART OF THE ATTACHMENTS TO THIS ORDINANCE; AND

WHEREAS, ALL DOCUMENTS AND RECORDS NEEDED TO PROCEED WITH ANNEXATION OF THE PROPERTIES INTO THE CORPORATE LIMITS OF THE CITY OF SOMERSET; AND

WHEREAS, THE PROPERTIES MEET ALL REQUIREMENTS FOR ANNEXATION AS SET FORTH IN KRS AND ALL OTHER APPLICABLE LAW;

NOW THEREFORE, BE IT ORDAINED BY THE CITY OF SOMERSET, KENTUCKY:

SECTION 1. THAT THE PROPERTIES DESCRIBED IN ATTACHMENTS HERETO, ATTACHMENTS INCORPORATED IN FULL BY REFERENCE, ARE HEREBY ANNEXED INTO THE CITY'S CORPORATE LIMITS.

**2880 WEST HIGHWAY 80-GROCERY AND FUEL**

SECTION 2. THIS ORDINANCE SHALL TAKE EFFECT AFTER ITS PASSAGE AND UPON PUBLICATION BY LAW.

FIRST READING: August 13, 2012

SECOND READING: August 27, 2012

APPROVED

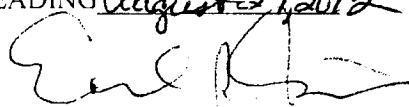

EDWARD R. GIRDLER, MAYOR  
CITY OF SOMERSET, KENTUCKY

ATTEST:

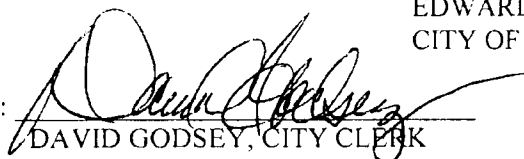

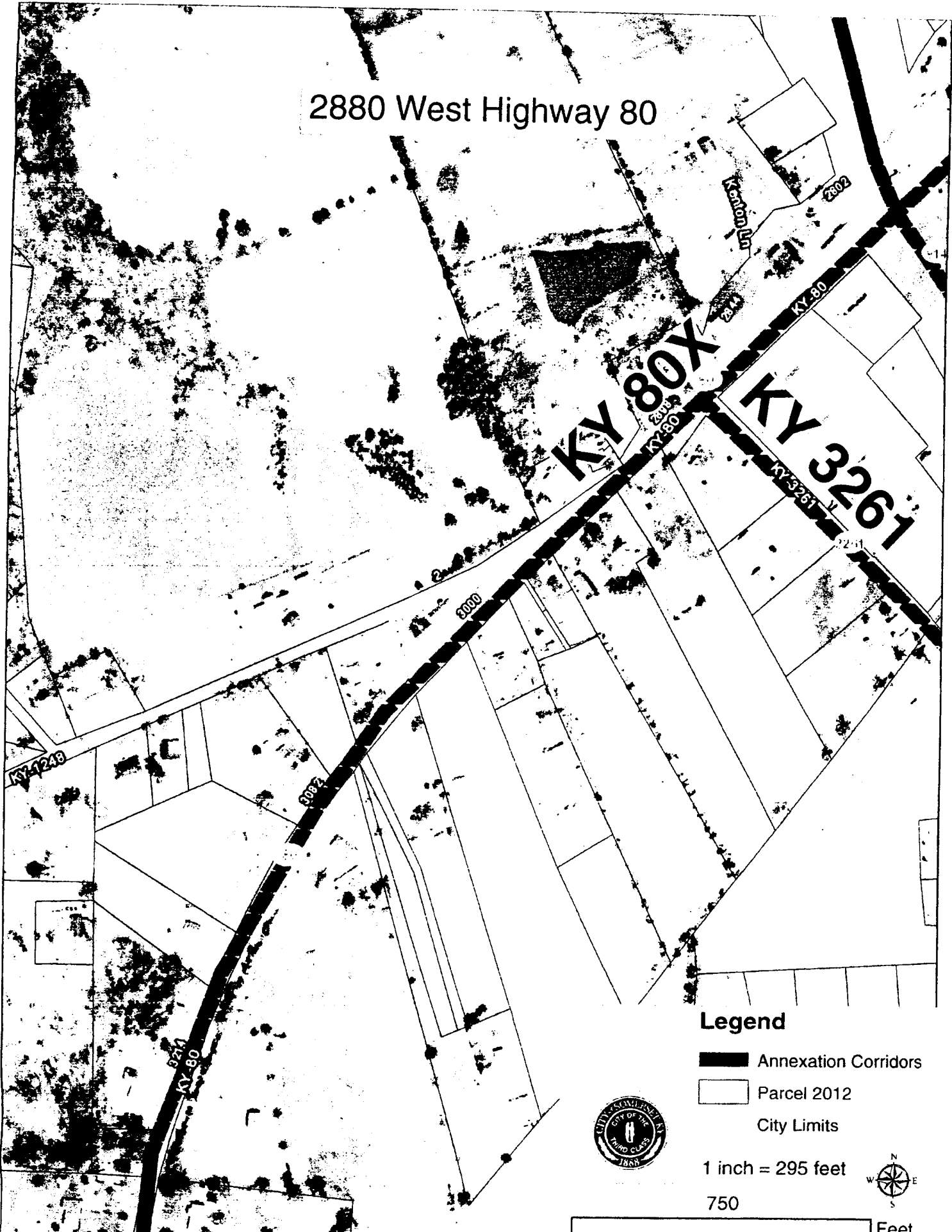

DAVID GODSEY, CITY CLERK

2880 West Highway 80



**Legend**

-  Annexation Corridors
-  Parcel 2012
-  City Limits



1 inch = 295 feet  
750

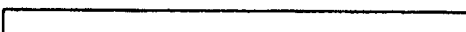

 Feet

**EXHIBIT "A"**

**City of Somerset, KY. Annexation Ordinance No. \_\_\_\_\_**

A certain tract or parcel of land located in Pulaski County Kentucky lying adjacent to the City of Somerset City Limits and is more particularly described as follows:

The following description was prepared by Jody Dagley PLS 3138 of JD Land Surveying, Inc. Description was prepared utilizing record information from the Pulaski County Court Clerk's office, in Somerset, Kentucky and Department of Highway plan sheets and existing pavement shots to establish right-of-ways. The purpose of this survey is to delineate the limits of the annexation. It does not in any way reflect a determination of the individual parcel boundaries and should not be used for this purpose.

**DESCRIPTION**

**BEGINNING** at a point at the intersection of Kentucky Highway 1248 and Highway 80, said point having a Kentucky SPC Single Zone of N 3,555,595.420; E 5,237,479.491; Thence with Hwy 80 S 44° 39' 41" W a distance of 150.05' to a point; Thence S 42° 45' 41" W a distance of 154.00' to a point; Thence with Joe Lee Daulton (deed book 246, page 297) N 17° 02' 19" W a distance of 117.00' to a point on Kentucky Hwy

1248 right-of-way and having a Kentucky SPC Single Zone N 3,555,487.496; E 5,237,235.182; Thence with Hwy 1248 N 66° 09' 41" E a distance of 102.80' to a point; Thence N 63° 50' 41" E a distance of 162.00' to a point; Thence S 44° 02' 19" E a distance of 7.00' to the **POINT OF BEGINNING**. Annexed boundary having an area of 15,672.9 sq. ft. and/or 0.36 acres

All bearings and distances described herein are based on Grid North Kentucky State Plane Single Zone(1600)

  
Jody C. Dagley PLS 3138

7-29-12  
Date

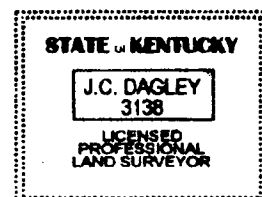

ANNEXATION REQUEST FORM

I, VIMLA PATEL formally request annexation

Of my property located

at 2880 WEST Highway 80 Somerset KY 40503

Somerset into the City of Somerset.

I also request that the 60 day waiting period be waived.

I am requesting that my property be zoned B2.

Sincerely,

VIMLA PATEL

Date 7-30-12